

Frozen
Frozen granita, creams and soft-ice
cream dispenser with 1 bowl and touch
screen, UK plug

ITEM # _____

MODEL # _____

NAME # _____

SIS # _____

AIA # _____



562528 (GTITR290)

* NOT TRANSLATED *

Main Features

- Can dispense up to 5 products among soft ice cream, frozen yogurt, chilled coffee cream, sorbet or slush.
- Can be used in specialised ice cream shops to dispense products specifically conceived for particular customer categories, like celiac or people who are lactose intolerant. Producing ice-cream with this equipment prevents any contamination, as the bowls d
- Ideal for bars, restaurants, hotels, cafeterias and catering companies for the production of delicious desserts and chilled specialties.
- The ITANK™ Technology prevents ice accumulation on the outer side of the bowl.
- Menu is available in Italian and English, but other languages can be programmed as well.
- Customizable touch screen display.
- Easy to use thanks to the adjustable push button control panel: when pressing it the rotation speed raises and the product is pushed out easily.

APPROVAL: _____



Electrolux
PROFESSIONAL

Frozen
Frozen granita, creams and soft-ice cream
dispenser with 1 bowl and touch screen, UK
plug

Front

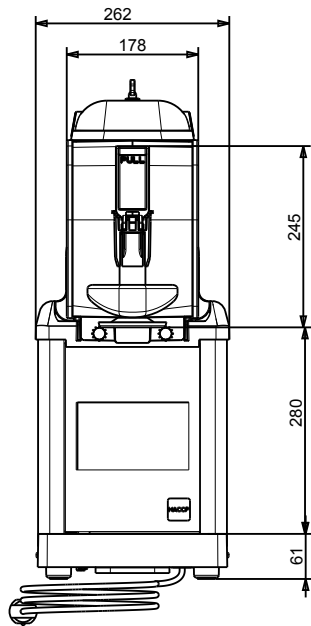

Side

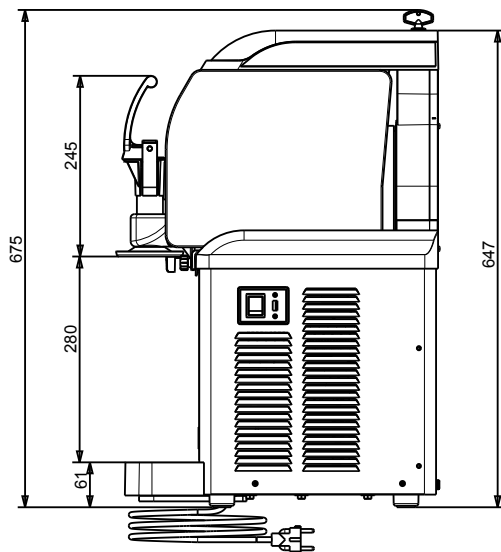

Top

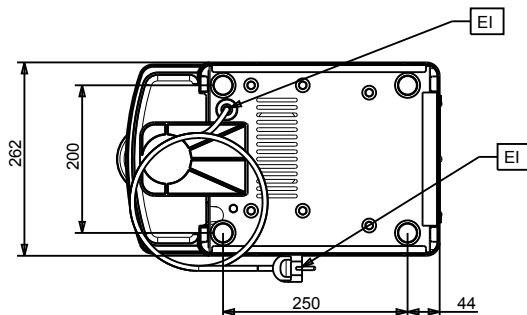

Frozen
Frozen granita, creams and soft-ice cream dispenser with 1 bowl and
touch screen, UK plug
The company reserves the right to make modifications to the products
without prior notice. All information correct at time of printing.

2025.04.10



Electrolux
PROFESSIONAL

Frozen
Frozen granita, creams and soft-ice cream
dispenser with 1 bowl and touch screen, UK
plug

Electric

Supply voltage: 220-240 V/1 ph/50 Hz
Electrical power max.: 0.385 kW

Key Information:

Net weight: 28 kg

Sustainability

Refrigerant type: R290
Refrigerant weight: 62 g



Frozen
Frozen granita, creams and soft-ice cream dispenser with 1 bowl and
touch screen, UK plug
The company reserves the right to make modifications to the products
without prior notice. All information correct at time of printing.

2025.04.10